

Freestate Lintels

P.O. Box 478, Hagerstown, MD 21741
301-739-6080

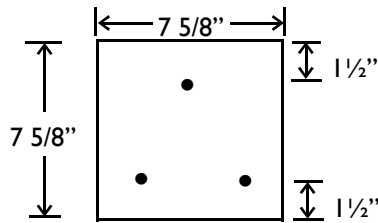

Typical Cross Section

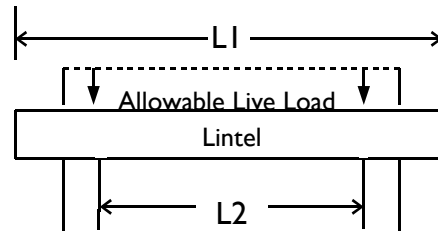

Loading Diagram

8" x 8" Cross Section Lintels

Nominal Lintel Length (L1)	Clear Span (L2)	Reinforcement		Calculated Maximum Allowable Superimposed, Uniformly Distributed Live Load in Pounds Per Lineal Foot*
		Top Bar	Bottom Bars	
36"	1' - 8"	One #3	Two #3	3400
40"	2' - 0"	One #3	Two #3	3100
44"	2' - 4"	One #3	Two #3	2830
48"	2' - 8"	One #3	Two #3	2550
52"	3' - 0"	One #3	Two #3	2260
56"	3' - 4"	One #3	Two #3	1930
60"	3' - 8"	One #3	Two #3	1600
64"	4' - 0"	One #3	Two #3	1310
68"	4' - 4"	One #3	Two #3	1065
72"	4' - 8"	One #3	Two #3	930
76"	5' - 0"	One #3	Two #3	800
80"	5' - 4"	One #3	Two #3	690
84"	5' - 8"	One #3	Two #3	600
88"	6' - 0"	One #3	Two #3	520
92"	6' - 4"	One #3	Two #4	480
96"	6' - 8"	One #3	Two #4	425
100"	7' - 0"	One #3	Two #5	385
104"	7' - 4"	One #3	Two #5	345
108"	7' - 8"	One #3	Two #5	305
112"	8' - 0"	One #3	Two #5	275
116"	8' - 4"	One #3	Two #5	240
120"	8' - 8"	One #3	Two #5	215
124"	9' - 0"	One #3	Two #5	190
128"	9' - 4"	One #3	Two #5	175
132"	9' - 8"	One #3	Two #5	155
136"	10' - 0"	One #3	Two #5	140
140"	10' - 4"	One #3	Two #5	125
144"	10' - 8"	One #3	Two #5	115

* The calculated sum of immediate live load deflection is less than L/600.

Design Criteria: ACI-318
Reinforcement Standard: ASTM-A615 Grade 60
Minimum Lintel Compressive Strength: 3,000 psi at 28 days
Lintel Design Dead Load: 29 Pounds per Lineal Foot